

R SERIES - 160/180 HEAD SPARE PARTS DIAGRAM

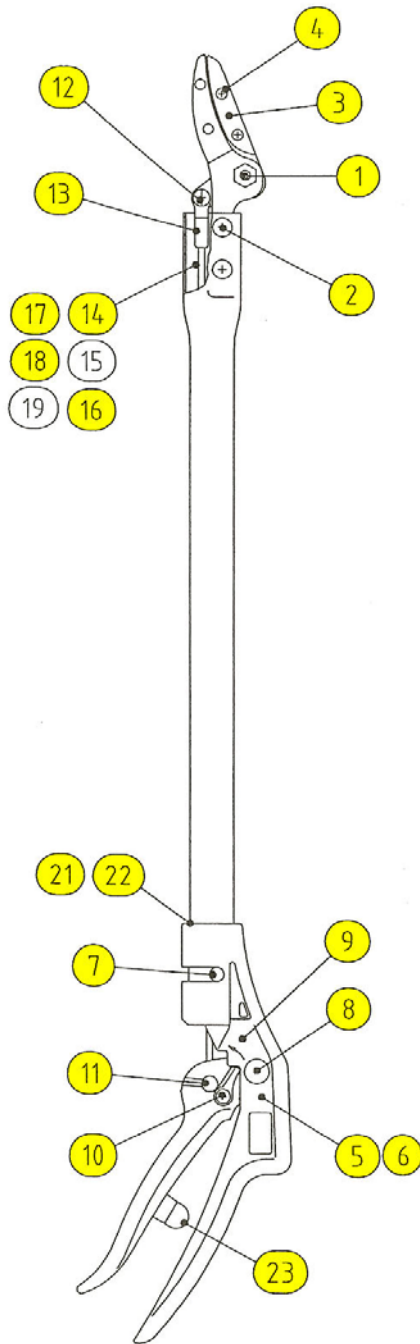

- | | | |
|-----|------------|-----------------------------------------------------------------|
| 1. | SP-LA30 | Pivot Bolt for Blade Sets |
| 2. | SP-LA31 | Screw, Washer, & Nut to Attach Blade to Pipe |
| 3. | SP-LA32 | Holding Device w/ 2 Screws for 160 Head |
| 4. | SP-LA33 | Screw for Holding Device for 160 Head |
| 5. | SP-16038A | Handle Set for 160 Units |
| 6. | SP-18038B | Handle Set for 180 Units |
| 7. | SP-LA39 | Stop Screw for Handle |
| 8. | SP-LA40 | Pivot Bolt for Handle |
| 9. | SP-LA41 | Spring for Handle |
| 10. | SP-LA42 | Latch Lock Set for Handle |
| 11. | SP-LA43 | End Cylinder for Rod |
| 12. | SP-LA44 | Screw Set, Connect Blade to Rod |
| 13. | SP-LA45 | Rod End Cap. (Bolt with loop to attach blade to rod) |
| 14. | SP-LA46 | Rod for LA-160/180R18
(includes end cylinder and rod endcap) |
| 15. | | Rod for LA-160/180R24 |
| 16. | SP-LA81 | Rod for LA-160R035 |
| 17. | SP-LA82 | Rod for LA-160R06 |
| 18. | SP-R180R12 | Rod for LA-160/180R12
(includes end cylinder and rod endcap) |
| 19. | SP-LA84 | Rod for LA-160/180R21— Special Order |
| 21. | SP-LA160HB | Sleeve for Grip of LA-160R035/06/12/18 |
| 22. | SP-LA180HB | Sleeve for Grip of LA-160R21/24, 180/190 Series |
| 23. | SP-LAXRC | Shock Absorber for Handle |

BLADE SETS:

- | | |
|----------|----------------------------------|
| SP-16027 | Replacement Cut & Hold Blade Set |
| SP-18028 | Replacement Razor Edge Blade Set |

*All highlighted items are available from inventory.
All others are available by Special Order.*